



March 25, 2024

Dear Neighbors in Holiday Hills and Le Villa Vaupell:

We continue to progress toward the successful completion of your public sanitary sewer system. The Holiday Hills/Le Villa Vaupell Sewer Extension will benefit the ecology of the entire region. Today we have several important updates to offer you.

Phase 2 is ready to begin. As Phase 1 has been completed for the initial 108 homes, we are preparing to embark on Phase 2 in May of 2024. The project scope of Phase 2 includes 6,200 lineal feet of sanitary sewer along Pine Street and Northeast Shore Drive within the Village of Holiday Hills and throughout Le Villa Vaupell subdivision to serve an additional 94 homes (see blue area on attached map). This project will require construction equipment to excavate and backfill the new sewer pipe and access to homes adjacent to construction activities may be limited during normal construction hours, but will be restored at the end of each day. Residents can expect traffic detours, construction noise and dust while the new sewer is being installed. Phase 2 is anticipated to be substantially completed by the end of 2024. We appreciate your patience while this work is being completed.

Grant funding. Phase 2 will be fully funded by three mechanisms: \$2,000,000 from McHenry County's allotment of the American Rescue Plan Act of 2021 funds; \$2,500,000 from the federal 2023 Consolidated Appropriations Act, and \$96,364 from McHenry County Community Development Block Grant. We are extremely grateful to our elected officials who have prioritized this project and secured this funding.

Private sewer connections and costs. Residents have several important factors to consider when preparing to decommission their septic system and connect to the public sewer:

1. Homeowners must hire a licensed, insured, and bonded contractor to perform the private sewer lateral installation and properly abandon the private sewage disposal system at their cost, following NMWRD standards and subject to inspection.
2. The McHenry County Health Department requires a permit, permit fee, and a site plan of the system components being removed prior to the private septic system being decommissioned.
3. Standard construction details are enclosed and available at www.nmwrld.org. All proposed sewer laterals shall include the installation of an isolation valve. **Please note the connection of sump pumps to the public sewer is prohibited by law.**

Connection fees and financing offer. In addition to your private construction costs, all residents will be responsible for the connection fee that all users in the region pay when their homes are constructed and

connected to the public sewer. Homeowners can either make a lump sum payment for their connection fee or take advantage of the unique financing option described below.

Lump sum option: Residents who initially connect to the new sanitary sewer will be treated the same as other new customers connecting to other parts of the NMWRD system and will be charged a connection fee (\$11,425.55 after May 1, 2024), plus a one-time \$100 inspection fee.

--or--

Financing offer: Each parcel is eligible to finance the connection fee if the parcel is connected within three years of the sewer being installed adjacent to the property. The connection fee will be financed at 4% annual interest over 30 years. The installments will be applied to the monthly bill. Those who finance the connection fee will pay the monthly sewer user fee (2024 rate of \$47.00/month) plus the monthly connection fee installment (approximately \$55/month), or a total monthly user bill of approximately \$102.00.

Homeowners will be required to apply for a connection permit from the NMWRD and choose a connection fee option prior to commencing work. Homeowners do not have to connect immediately, but all will be required to connect to the sanitary sewer by December 31, 2038, or when their current private septic system fails, whichever comes first.

Further information and downloads. Please visit www.nmwrld.org and click on the HOLIDAY HILLS tab in the menu stretching across the top banner. Among other links and downloads, you will find 1) the *Sanitary Sewer Service Permit Application Form*, 2) the *Sanitary Sewer Service Standard Specifications and Design Requirements*, and 3) the *McHenry County Private Sewage Disposal System Permit*. By visiting www.mchenrycountyil.gov you will find a list of qualified companies to prepare the necessary septic abandonment for your property.

Please note the Village of Holiday Hills will not be involved with the sanitary sewer or private connections and all questions and concerns about the sewer system should be directed to the NMWRD's Jasmin Bait (jasmin@nmwrld.org or 847-526-3300). We look forward to working with you!

Sincerely,



Mohammed Haque, District Manager
Northern Moraine Wastewater Reclamation District



Attachments:

1. Sewer Exhibit
2. Sanitary Sewer Service Permit Application Form
3. Relevant Construction Details - In-Line Disconnect Tee and Riser; Sanitary Sewer Service Layout

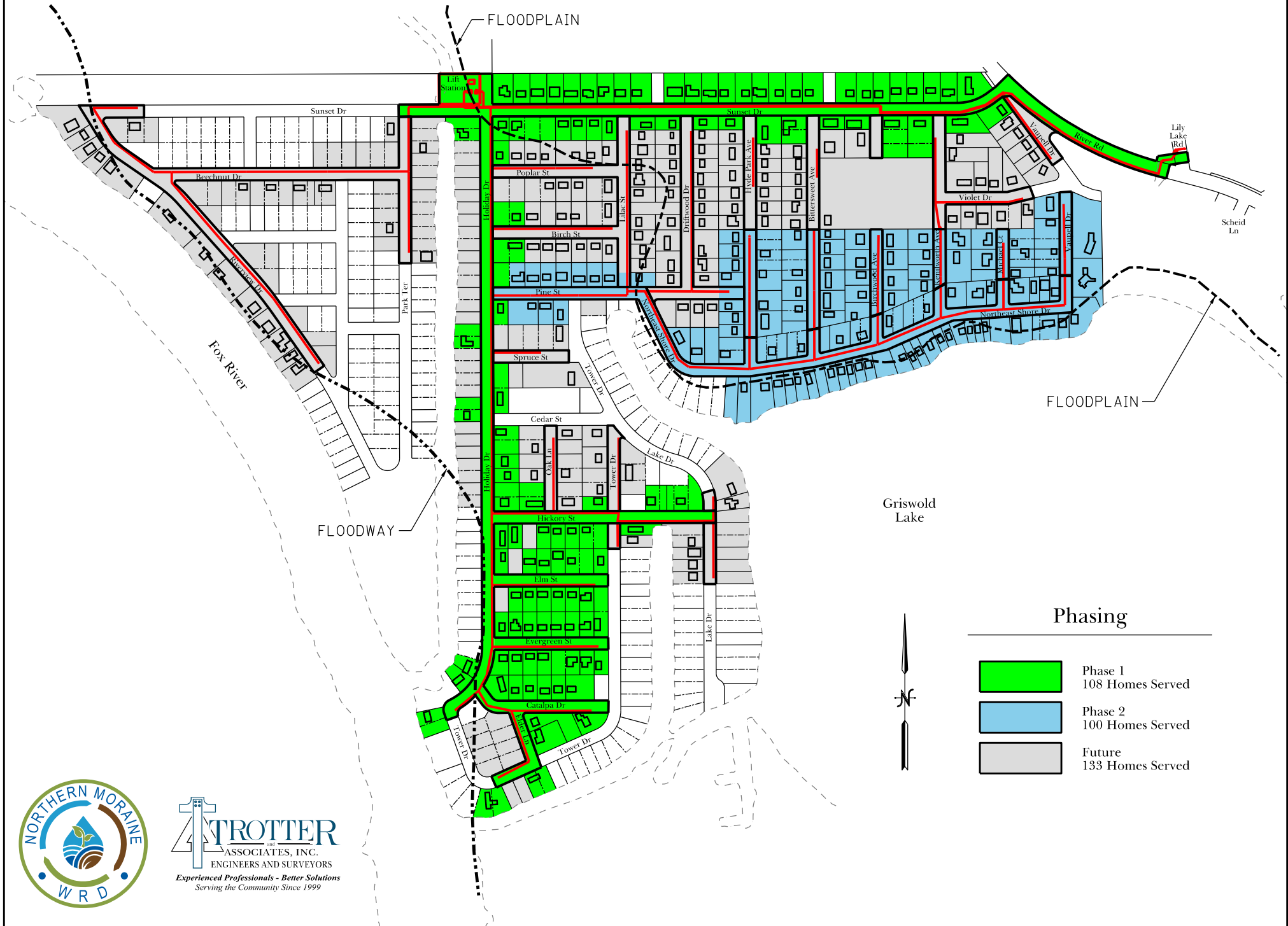
Holiday Hills / Le Villa Vaupell Sewer Extension - Phase 2



Phasing

	Phase 1 108 Homes Served
	Phase 2 100 Homes Served
	Future 133 Homes Served





NORTHERN MORaine
W R D

Sanitary Sewer Service – Permit Application Form

Fee: _____ Date Paid: _____

Owner's Name _____ Phone _____ Email _____

Service Address _____ City _____ Zip Code _____

Billing Address _____ City _____ Zip Code _____

LEGAL DESCRIPTION

Tax Parcel # _____ County _____ Township _____

Block _____ Lot _____ Subdivision _____

Sewer Contractor _____ Phone _____ Email _____
Bond # _____

WORK DESCRIPTION: _____

**RETURN FORM TO INFO@NMWRD.ORG OR IN PERSON AT 113 TIMBER TRAIL,
ISLAND LAKE, IL 60042**

CALL JULIE BEFORE DIGGING 1-800-892-0123

CALL LOCAL POLICE & FIRE DEPARTMNETS IF ROAD WILL BE CLOSED FOR CONSTRUCTION

**24 HOUR NOTICE MUST BE GIVEN TO NMWRD FOR INSPECTION BEFORE
COMMENCING WORK AT 1-847-526-3300**

**CONTRACTOR MUST HAVE A LICENSE & PERMIT BOND AND
CERTIFICATE OF INSURANCE ON FILE WITH THE DISTRICT**

NO WEEKEND INSPECTIONS



113 Timber Trail, PO Box
240, Island Lake, IL 60042



Phone: 847-526-3300
Fax: 847-526-3349



Email: info@nmwrdd.org
Web: www.nmwrdd.org

EXHIBIT A

(EXAMPLE)

ACORD TM CERTIFICATE OF LIABILITY INSURANCE						DATE (MM/DD/YYYY) Completed	
PRODUCER				THIS CERTIFICATE IS ISSUED AS A MATTER OF INFORMATION ONLY AND CONFERS NO RIGHTS UPON THE CERTIFICATE HOLDER. THIS CERTIFICATE DOES NOT AMEND, EXTEND OR ALTER THE COVERAGE AFFORDED BY THE POLICIES BELOW.			
Fully Completed				INSURERS AFFORDING COVERAGE		NAIC #	
INSURED				INSURER A: Name of Insurance Company		Completed	
Fully Completed				INSURER B: Name of Insurance Company		Completed	
				INSURER C: Name of Insurance Company		Completed	
				INSURER D: Name of Insurance Company		Completed	
				INSURER E: Name of Insurance Company		Completed	
COVERAGES							
THE POLICIES OF INSURANCE LISTED BELOW HAVE BEEN ISSUED TO THE INSURED NAMED ABOVE FOR THE POLICY PERIOD INDICATED. NOTWITHSTANDING ANY REQUIREMENT, TERM OR CONDITION OF ANY CONTRACT OR OTHER DOCUMENT WITH RESPECT TO WHICH THIS CERTIFICATE MAY BE ISSUED OR MAY PERTAIN, THE INSURANCE AFFORDED BY THE POLICIES DESCRIBED HEREIN IS SUBJECT TO ALL THE TERMS, EXCLUSIONS AND CONDITIONS OF SUCH POLICIES. AGGREGATE LIMITS SHOWN MAY HAVE BEEN REDUCED BY PAID CLAIMS.							
INSR LTR	ADD'L INSRD	TYPE OF INSURANCE	POLICY NUMBER	POLICY EFFECTIVE DATE (MM/DD/YY)	POLICY EXPIRATION DATE (MM/DD/YY)	LIMITS	
A	X	GENERAL LIABILITY CG001 <input checked="" type="checkbox"/> COMMERCIAL GENERAL LIABILITY <input type="checkbox"/> CLAIMS MADE <input checked="" type="checkbox"/> OCCUR <input checked="" type="checkbox"/> OWNERS & CONT PROT (IF REQUIRED) <input type="checkbox"/> _____ GEN'L AGGREGATE LIMIT APPLIER PER: <input type="checkbox"/> POLICY <input type="checkbox"/> PROJECT <input type="checkbox"/> LOC	Policy Number	Policy Start Date	Policy End Date	EACH OCCURRENCE	\$ 1,000,000
						DAMAGE TO RENTED PREMISES (Ea. Occur.)	\$ 50,000
						MED EXP (Any one person)	\$ 5,000
						PERSONAL & ADV INJURY	\$ 1,000,000
						GENERAL AGGREGATE	\$ 2,000,000
						PRODUCTS-COMP/OP AGG	\$ 1,000,000
A		AUTOMOBILE LIABILITY CA001 <input checked="" type="checkbox"/> ANY AUTO CA001 <input type="checkbox"/> ALL OWNED AUTOS <input type="checkbox"/> SCHEDULED AUTOS <input type="checkbox"/> HIRED AUTOS <input type="checkbox"/> NON-OWNED AUTOS <input type="checkbox"/> _____	Policy Number	Policy Start Date	Policy End Date	COMBINED SINGLE LIMIT (Ea. Accident)	\$ 1,000,000
						BODILY INJURY (PER PERSON)	\$
						BODILY INJURY (PER ACCIDENT)	\$
						PROPERTY DAMAGE (PER ACCIDENT)	\$
		GARAGE LIABILITY <input type="checkbox"/> ANY AUTO				AUTO ONLY-EA ACCIDENT	\$
						OTHER THAN EA ACC	\$
						AUTO ONLY: AGG	\$
B	X	EXCESS UMBRELLA LIABILITY <input checked="" type="checkbox"/> OCCUR <input type="checkbox"/> CLAIMS MADE <input type="checkbox"/> DEDUCTIBLE <input type="checkbox"/> RETENTION \$	Policy Number	Policy Start Date	Policy End Date	EACH OCCURRENCE	\$ per request
						AGGREGATE	\$ per request
C		WORKERS COMPENSATION AND EMPLOYERS' LIABILITY ANY PROPRIETOR/PARTNER/EXECUTIVE OFFICER/MEMBER EXCLUDED? NO If yes, describe under SPECIAL PROVISIONS below	Policy Number	Policy Start Date	Policy End Date	<input checked="" type="checkbox"/> WC STATU- <input type="checkbox"/> OTHER TORY LIMITS	
						E.L. EACH ACCIDENT	\$ 500,000
						E.L. DISEASE-EA EMPLOYEE	\$ 500,000
						E.L. DISEASE-POLICY LIMIT	\$ 500,000
		OTHER Professional Liability (If requested)	Policy Number	Policy Start Date	Policy End Date		
DESCRIPTION OF OPERATIONS/LOCATIONS/VEHICLES/EXCLUSIONS ADDED BY ENDORSEMENT/SPECIAL PROVISIONS							
List project number, location and description. No endorsements or additional forms modify or limit coverage provided to additional insured. Coverage provided to the additional insured is primary.							
CERTIFICATE HOLDER				CANCELLATION			
Additional Insured: Member, its officials, employees, agents and volunteers.				SHOULD ANY OF THE ABOVE DESCRIBED POLICIES BE CANCELLED BEFORE THE EXPIRATION DATE THEREOF, THE ISSUING INSURER WILL MAIL 30 DAYS WRITTEN NOTICE TO THE CERTIFICATE HOLDER NAMED TO THE LEFT.			
				SIGNATURE OF AUTHORIZED AGENT			

EXHIBIT E
NMWRD SAMPLE BOND

INSURANCE COMPANY

BOND NO. 14-

ILLINOIS
LICENSE AND/OR PERMIT BOND
(ONLY VALID IF FILLED IN FOR LESS THAN \$25,001.00
AND OBLIGEE IS AN ILLINOIS COUNTY, CITY, TOWN OR VILLAGE.)

KNOW ALL MEN BY THESE PRESENTS:

That we _____
(Principal's Name)

(Principal's Address)

as Principal, and BOND SAFEGUARD INSURANCE COMPANY, an insurance company duly licensed in the State of Illinois, as Surety, are held and firmly bound unto _____

State of Illinois, Obligor, in the aggregate sum of Ten-thousand and 00/100 Dollars (\$10,000.00) to the payment of which sum the said Principal and Surety bind themselves and their heirs, administrators, executors, successors and assigns, jointly and severally by these presents.

In consideration thereof, the Principal is granted a license and/or permit by the Obligor to engage in the business of sewer hook-up

for the period beginning on the 30th day of May, 2003
and ending on the 30th day of May, 2004

THEREFORE: the condition of this bond is that, if said Principal shall comply with all of the conditions of the ordinances and regulations of the Obligor pertaining to said license and/or permit, then this obligation shall be null and void; otherwise to remain in full force and effect subject to the following conditions:

1. This obligation may be extended from year to year at the option of the Surety, by continuation certificate executed by the Surety;
2. This obligation may be cancelled by the Surety upon giving thirty (30) days written notice to the Obligor. However, this obligation shall remain in full force and effect as to the acts or omissions of the above mentioned Principal prior to the cancellation of the bond.

Dated this 30th day of May, 2003

Countersigned:

Principal

Officer

BOND SAFEGUARD INSURANCE COMPANY

BY: _____
Agent

BY: _____
President

ACKNOWLEDGEMENT OF SURETY
(Corporate Officer)

STATE OF ILLINOIS)
COUNTY OF DUPAGE) SS



On this 15th day of November, 2001, before me, the undersigned officer personally appeared David E. Campbell, who acknowledged himself to be the aforesaid officer of BOND SAFEGUARD INSURANCE COMPANY, a corporation, and that he, as such officer, being authorized to do so, executed the foregoing instrument for the purpose therein contained, by signing the name of the corporation by himself as such officer. IN WITNESS WHEREOF, I have hereunto set my hand and official seal.

"OFFICIAL SEAL"

ILLP2, 12/01

Notary Public, State of Illinois

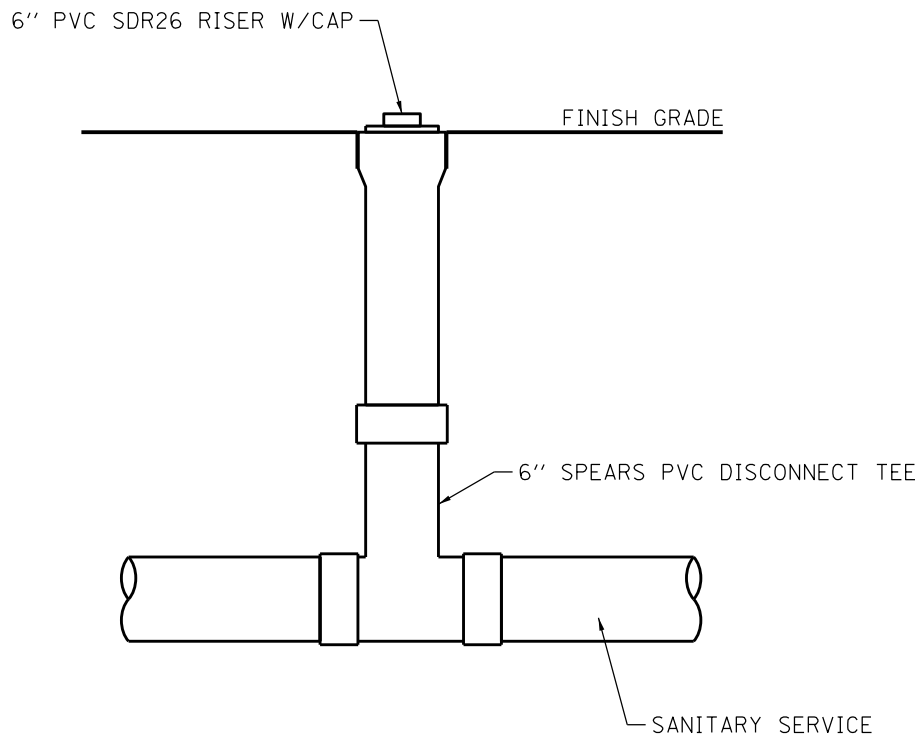

Northern Moraine Wastewater
Reclamation District

113 Timber Trail Island Lake, Illinois 60042
847.526.3300 Fax: 847.526.3349



In-Line Disconnect
Tee and Risier



Valves Product Sewer Disconnect

Spears® Sewer Disconnect functions as both cleanout and disconnect device, plus helps prevent sewage backup during hurricanes and floods. Complete unit consists of body and plunger (sold separately - both parts are required for proper use). The plunger can be screwed into the body to block solids waste flow. The plunger should be removed from the body and stored when not in use to prevent accidental closing (i.e., from ground vibration, etc.).



- Connects directly to 4" or 6" SDR-35 (or any ASTM D3034/D2729) PVC Sewer Pipe.
- Easily adapted to 4" or 6" Schedule 40 PVC Drainage Pipe with addition of IPS x Sewer Adapters, Socket x Spigot, Spears® part no. 3729-04013IXS for 4" or 3729-06013IXS for 6".
- User-supplied standpipe can be installed to grade using PVC Sewer Pipe connected to the body branch socket and a Sewer Cap to close off (Spears® part no. 4047-040 for 4" or 4047-060 for 6"). Optionally, user-supplied Schedule 40 Pipe can be used for standpipe with addition of a Schedule 40 DWV Socket Coupling (Spears® part no. P100-040 for 4" or P100-060 for 6") and Cap (Spears® part no. P116-040 for 4" or P116-060 for 6").
- T-handle for Plunger operation can be easily fabricated from user-supplied 1" Schedule 40 Pipe and Tee fitting (Spears® part no. 401-010).



Note - the unit restricts flow by approximately 85%. As a result, the unit must be located in the sewer line where solids are present. Full disconnect is not achieved without solids in the flow.

Auxiliary Components (Purchased Separately)

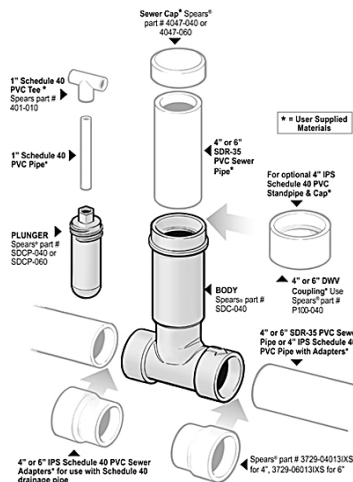

4" Basic Dimensions

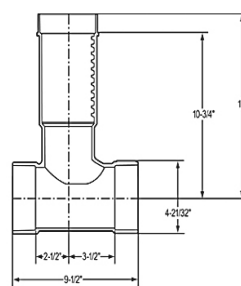

6" Basic Dimensions

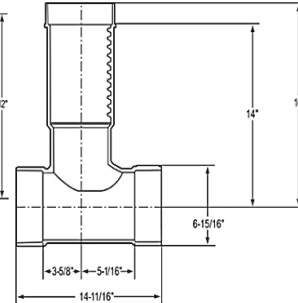

Sewer Disconnect

Sewer Disconnect Body

Part Number	Size	Std Pk	Mstr Ctn	Prod Code
-------------	------	--------	----------	-----------

Sewer Socket X Sewer Socket.

Requires Purchase of SDCP-040 or SDCP-060 Plunger

SDC-040	4	6	0	055
SDC-060	6	2	0	055

Sewer Disconnect Plunger

Part Number	Size	Std Pk	Mstr Ctn	Prod Code
-------------	------	--------	----------	-----------

For Use With Sewer Disconnect

Body Purchased Separately.

Requires Purchase of SDC-040 or SDC-060 Body

SDCP-040	4	12	0	055
----------	---	----	---	-----

Sewer Disconnect Plunger (continued)

Part Number	Size	Std Pk	Mstr Ctn	Prod Code
-------------	------	--------	----------	-----------

For Use With Sewer Disconnect

Body Purchased Separately.

SDCP-060	6	6	0	055
----------	---	---	---	-----

Optional IPS x SEWER Adapter

IPS Socket x Sewer Spigot for adapting Sewer Disconnect Body to Schedule 40 drainage pipe

3729-04013IXS	4	1	90	399
3729-06013IXS	6	1	15	399



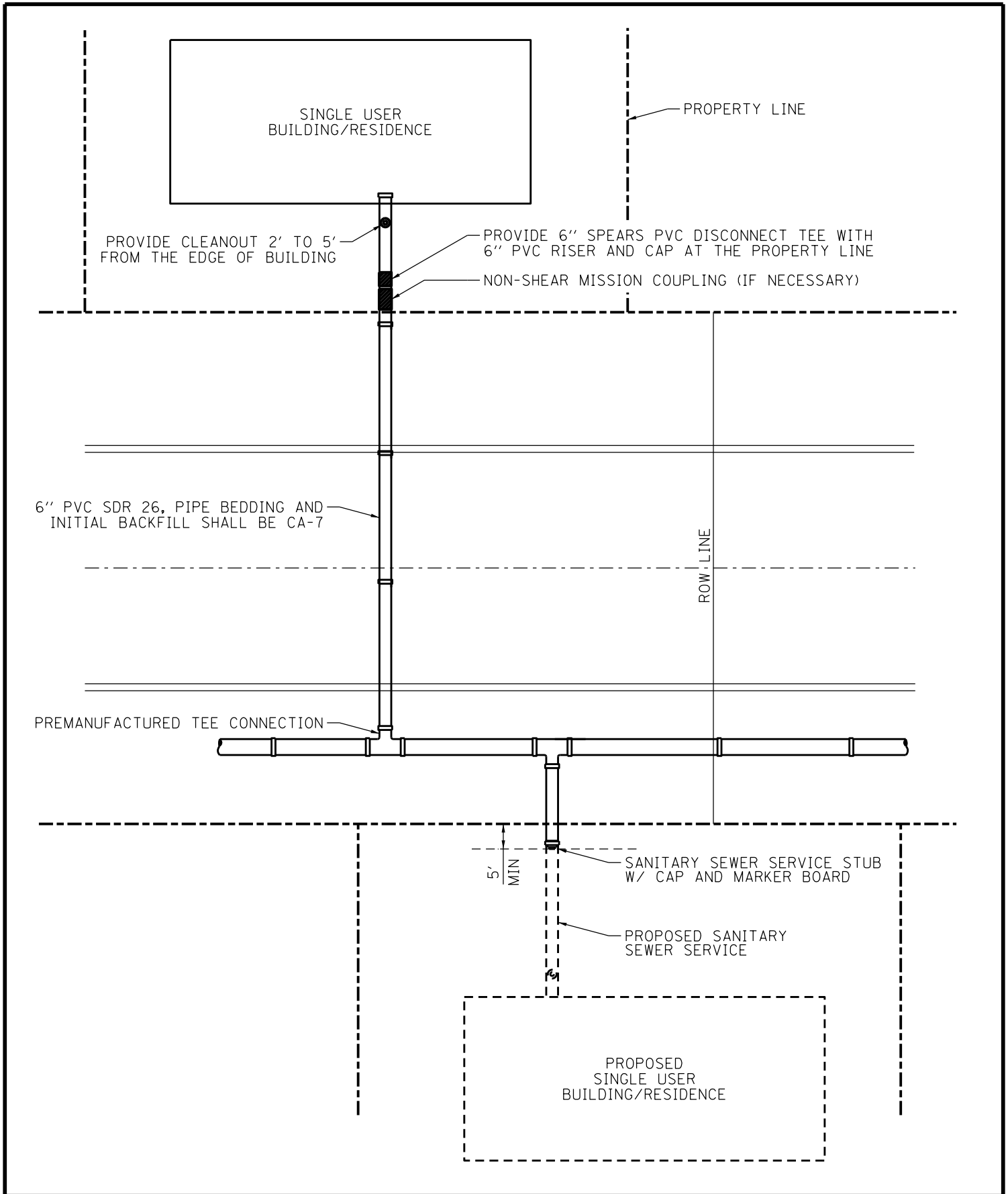

**Northern Moraine Wastewater
Reclamation District**

113 Timber Trail Island Lake, Illinois 60042
847.526.3300 Fax: 847.526.3349

**Sanitary Sewer
Service Layout**